

Notice of traffic lights and road closures, A422, Westbury

August 2025 | www.hs2.org.uk

High Speed Two (HS2) is the new high speed railway for Britain. If you have any questions about these works, please contact our Helpdesk to find out more. You can sign up for regular updates in your local area at www.hs2inbucksandox.co.uk.

What are we doing?

We are building a new bridge and section of road across the HS2 line on the A422 near Westbury. As part of the preparatory work, we are re-routing underground services and making new utility connections.

To facilitate these works we will need a series of traffic management and road closures. The maps below show the locations of the closure points and the traffic management.

EKFB will manage the closures and traffic lights on behalf of Anglian Water. New water pipes will be installed and connected.

When will these works take place?

Road closures:

- 6:00am Saturday 13 September to 11:59pm Sunday 14 September 2025
- 8:00pm Friday 19 September to 11:59 pm Sunday 21 September 2025.

Traffic Management:

There will be traffic lights on the A422 between Brackley and Westbury. The lights will be at alternate locations detailed in the map below.

- Monday 28 July to Friday 12 September 2025
- Monday 15 September to Friday 10 October 2025
- Monday 13 October to Thursday 23 October 2025.

If you have a question about HS2 or our works, please contact our HS2 Helpdesk team on 08081 434 434 or email hs2enquiries@hs2.org.uk

Notification



Duration of works

Road closures:

- 13 September to 14 September 2025
- 19 September to 21 September 2025

Traffic management:

- 28 July to 12 September 2025
- 15 September to 10 October 2025
- 13 October to 23 October 2025

What to expect

There may be slight delays caused by traffic lights. We aim to keep disruptions to a minimum.

We will continue to collaborate with the blue light services regarding access through our closures.

What we will do

Manage any environmental impacts, such as traffic and noise.

Respond promptly to any complaints.

Notice of traffic lights and road closures, A422, Westbury

www.hs2.org.uk

Notification



What section of the A422 will be closed?

The map below, shows the section of the A422 that will be closed and the approved diversion route.

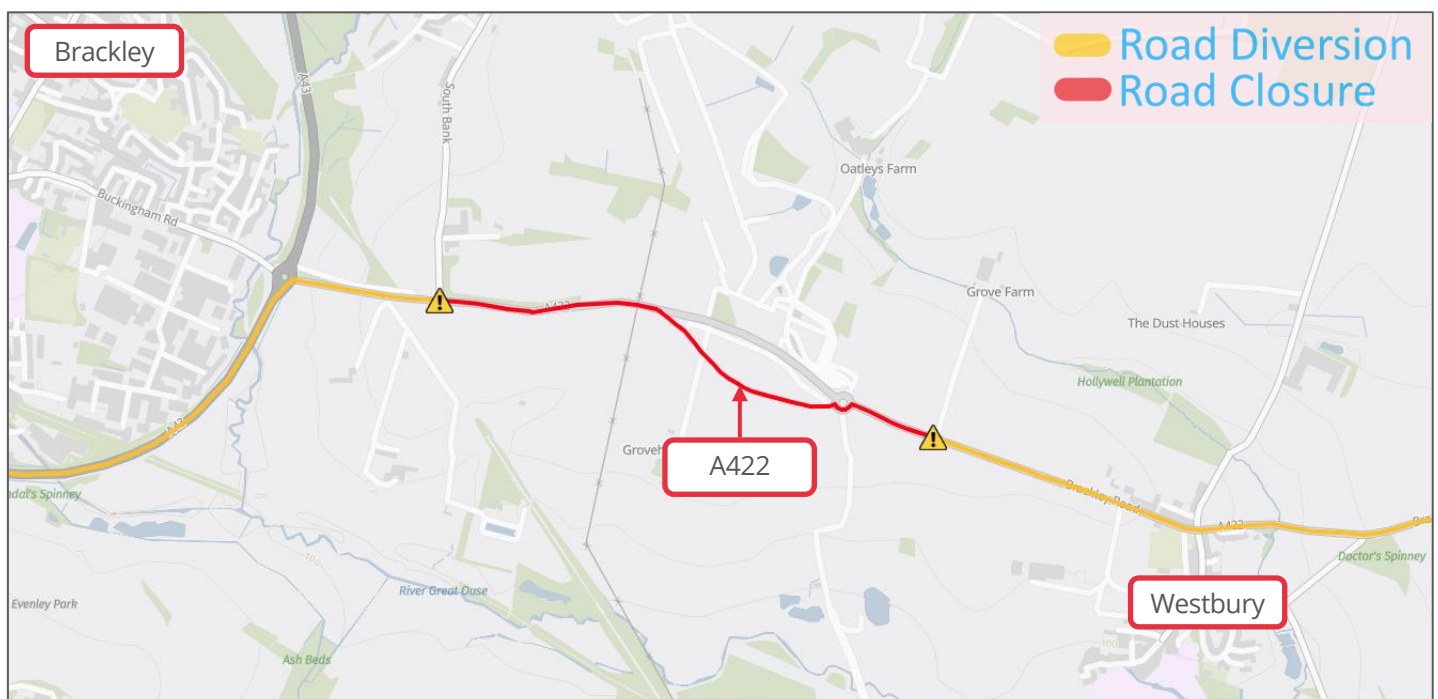
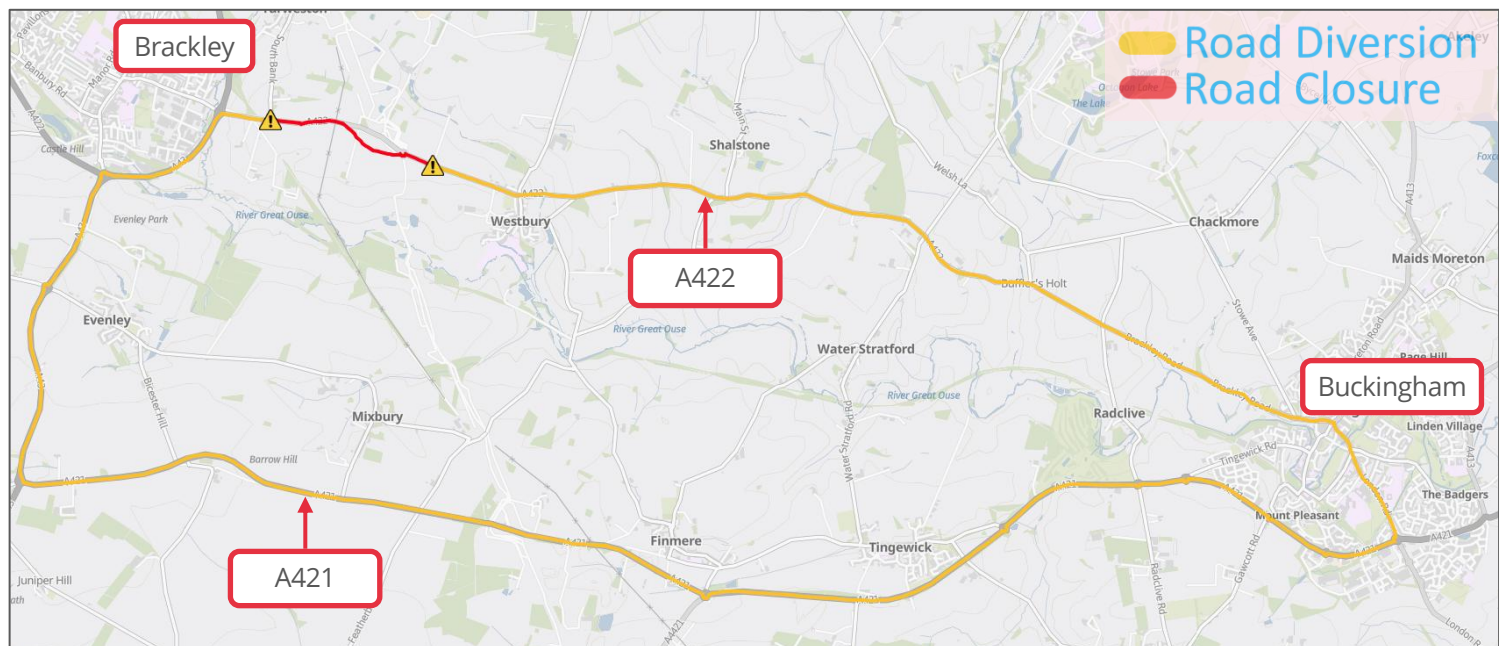

Notice of traffic lights and road closures, A422, Westbury

www.hs2.org.uk

Notification



Where will the lights be in place along the A422?

The map below shows the location of traffic lights on the A422.

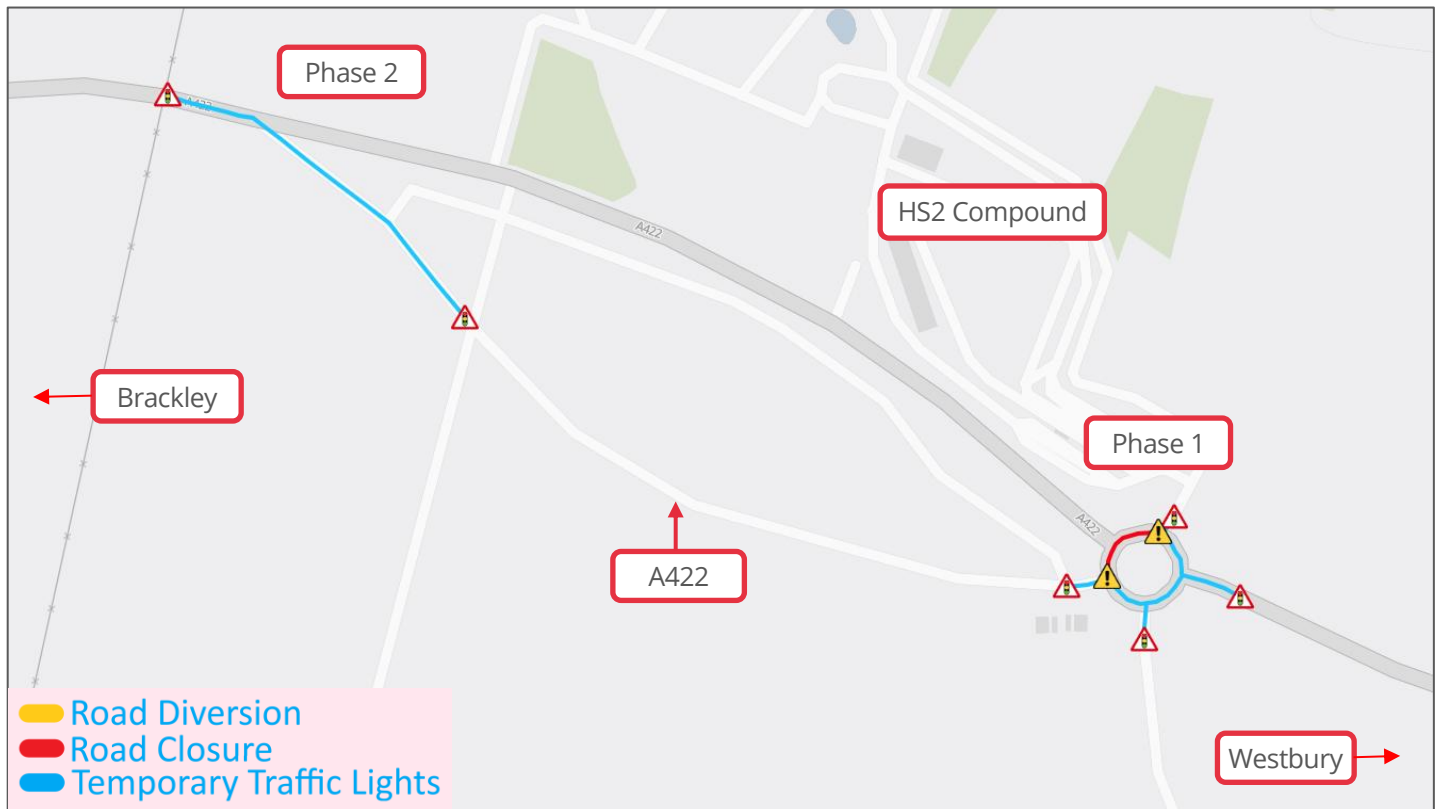

Keeping you informed

We are committed to keeping you informed about work on HS2. This includes ensuring you know what to expect and when to expect it, as well as how we can help.

Residents' Charter and Commissioner

The Residents' Charter is our promise to communicate as clearly as we possibly can with people who live along or near the HS2 route.
www.gov.uk/government/publications/hs2-residents-charter

We also have an independent Residents' Commissioner whose job is to make sure we keep to the promises we make in the Charter and to keep it under constant review. Find reports at:
www.gov.uk/government/collections/hs2-ltd-residents-commissioner

You can contact the Commissioner at:
residentscommissioner@hs2.org.uk

Construction Commissioner

The Construction Commissioner's role is to mediate and monitor the way in which HS2 Ltd manages and responds to construction complaints. You can contact the Construction Commissioner by emailing:
complaints@hs2-cc.org.uk

Property and compensation

You can find out all about HS2 and properties along the line of route by visiting:
www.gov.uk/government/collections/hs2-property
Find out if you're eligible for compensation at:
www.gov.uk/claim-compensation-if-affected-by-hs2

Holding us to account

If you are unhappy for any reason you can make a complaint by contacting our HS2 Helpdesk team. For more details on our complaints process, please visit our website:
www.hs2.org.uk/how-to-complain

Contact Us

Contact our HS2 Helpdesk team all day, every day of the year on:

 Freephone **08081 434 434**

 Minicom **08081 456 472**

 Email **hs2enquiries@hs2.org.uk**

Write to:

FREEPOST

HS2 Community Engagement

Website **www.hs2.org.uk**

To keep up to date with what is happening in your local area, visit:
www.hs2inyourarea.co.uk

Please contact us if you'd like a free copy of this document in large print, Braille, audio or easy read. You can also contact us for help and information in a different language.

HS2 Ltd is committed to protecting personal information. If you wish to know more about how we use your personal information please see our Privacy Notice
<https://www.gov.uk/government/publications/high-speed-two-ltd-privacy-notice>

Reference number: HS2-EKFB-25-1157

High Speed Two (HS2) Limited, registered in England and Wales.
Registered office: Two Snowhill, Snow Hill Queensway, Birmingham B4 6GA.
Company registration number: 06791686. VAT registration number: 888 8512 56.